

ROOM LAYOUTS

CONFERENCE CENTRE

The conference centre has raked seating for 300. It is surrounded by a large foyer area suitable for catering and exhibitions.

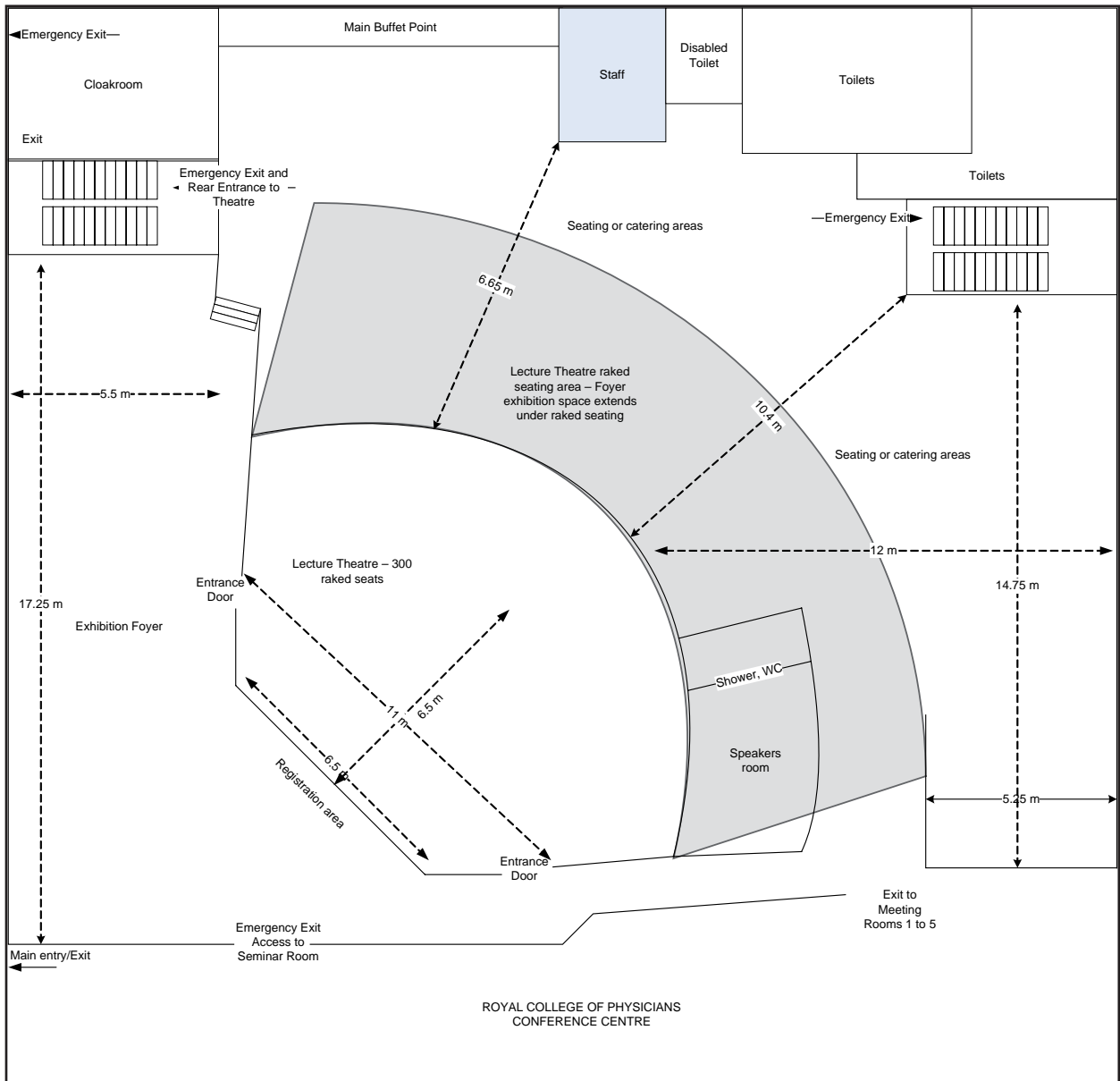

ROOM LAYOUTS

MEETING ROOMS 1-5 AND SEMINAR ROOM

Meeting Rooms 1 to 5 and the Seminar Room are directly accessible from the Conference Centre. These rooms do not have wheelchair access.

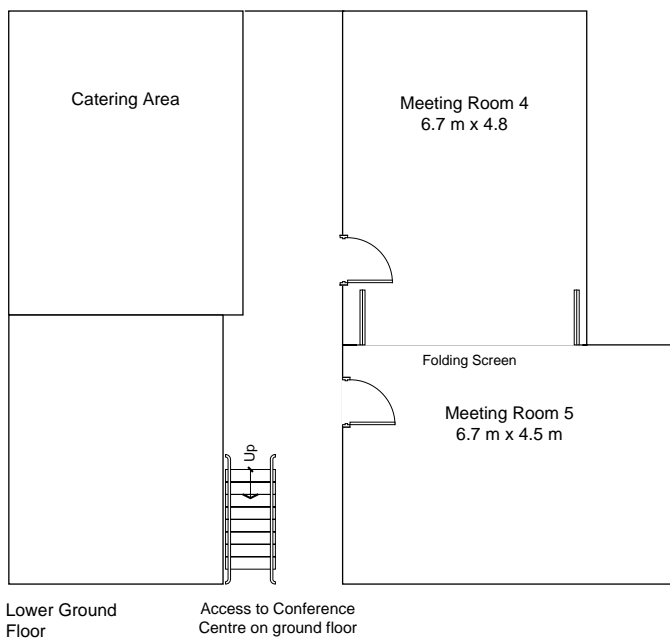
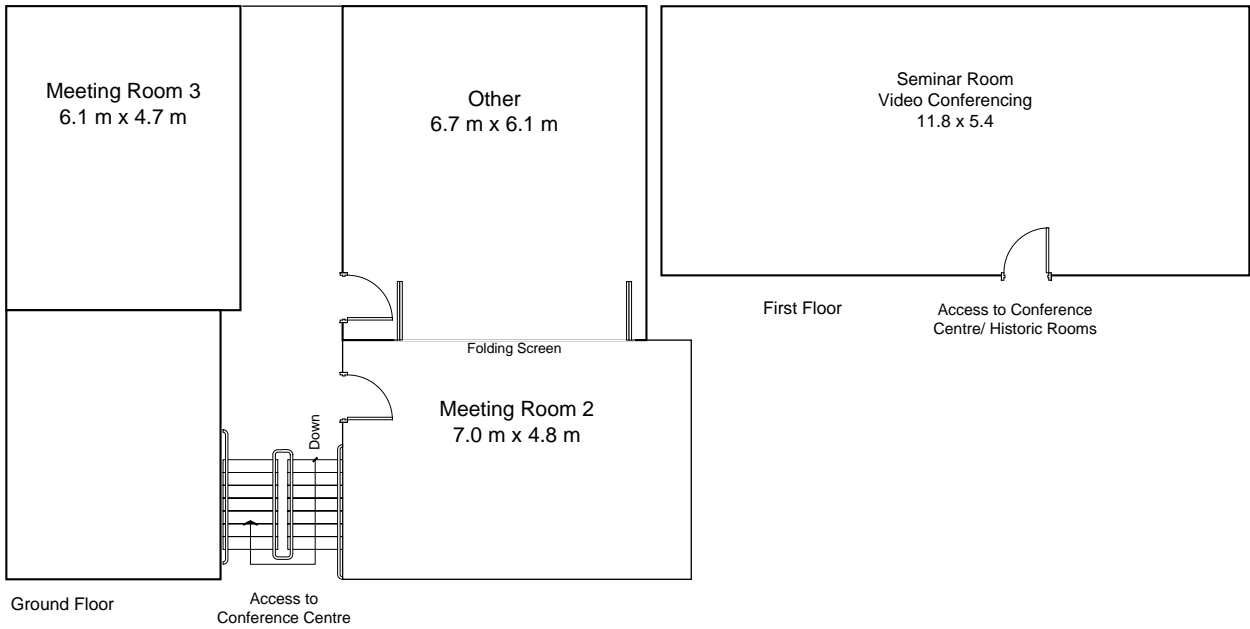

ROOM LAYOUTS

HISTORIC ROOMS

The historic rooms are all wheelchair accessible and are on the first floor of the building.

